

User Manual

MAGNUS

Variable Speed DC Pump

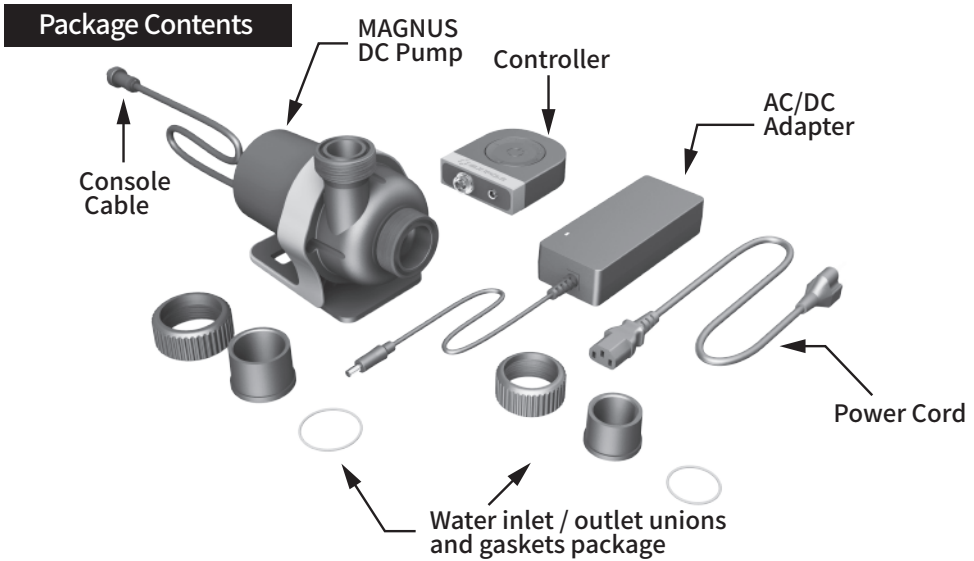

Smart Controller



Flow Adjustment
Six-step speed adjustment
(Adjusted Range 10%-100%).



Hangable
Hook design, more convenient to prevent scratches by the rubber mat.



Feed Mode
Press FEED button for pausing 10 mins or press again to resume.



Memory Function
Automatically remembers and resumes the last flow ratio value after the power is restored.



Over Load Protection Function
If the pump gets stuck or abnormal current occurs, this may cause the pump to malfunction. The controller will display an error indicator (as the left figure) and the pump will stop working instantly. Please disconnect the power and clean the pump.

Product Specifications

VSY-4000



Flow : 4,000 lph (1,055 gph)
 Max Head : 3.5 m (11.5')
 Wattage : 30 W
 Operating Voltage : 110-230 V / 50-60 Hz
 Weight : 1.03 kg (The pump)
 Cable Length : 3 m (The pump to the controller)
 Color : Yellow

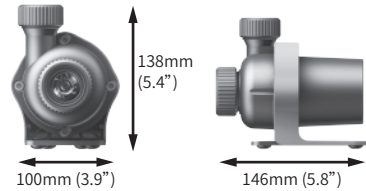

	Inlet	Outlet
Threaded	1½" (40mm)	1¼" (32mm)
Quick couple	1" (25mm)	¾" (20mm)

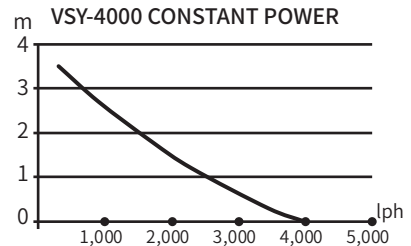

VSG-6000



Flow : 6,000 lph (1,580 gph)
 Max Head : 4.9 m (16')
 Wattage : 50 W
 Operating Voltage : 110-230 V / 50-60 Hz
 Weight : 1.52 kg (The pump)
 Cable Length : 3 m (The pump to the controller)
 Color : Green

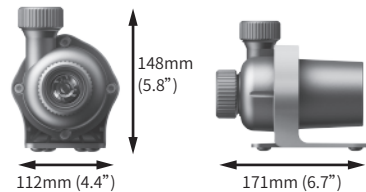

	Inlet	Outlet
Threaded	1½" (40mm)	1¼" (32mm)
Quick couple	1" (25mm)	¾" (20mm)

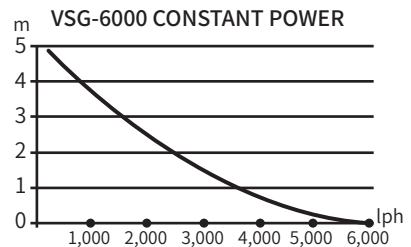

VSR-9000



Flow: 9,000 lph (2,370 gph)
 Max Head: 5.6 m (18')
 Wattage: 85 W
 Operating Voltage: 110-230 V / 50-60 Hz
 Weight: 1.52 kg (The pump)
 Cable Length: 3 m (The pump to the controller)
 Color: Red

	Inlet	Outlet
Threaded	1½" (40mm)	1¼" (32mm)
Quick couple	1" (25mm)	¾" (20mm)

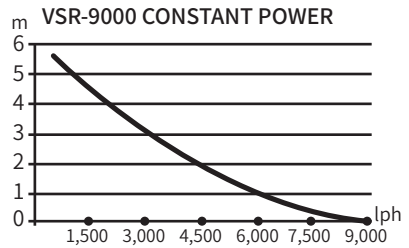
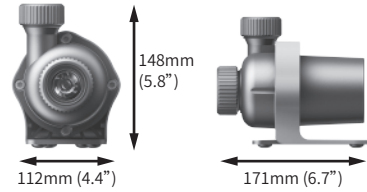

VSB-12000



Flow: 12,000 lph (3,170 gph)
 Max Head: 6.5 m (21')
 Wattage: 150 W
 Operating Voltage: 110-230 V / 50-60 Hz
 Weight: 2.17 kg (The pump)
 Cable Length: 3 m (The pump to the controller)
 Color: Blue

	Inlet	Outlet
Threaded	2" (50mm)	1½" (40mm)
Quick couple	1¼" (32mm)	1" (25mm)

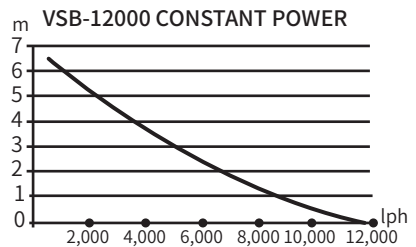
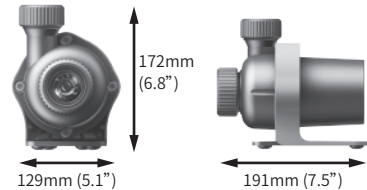

Flexibility Setup

Submersed and Inline

The MAGNUS is a return pump which can be run either submersed or inline.



Submersed

The pump should be placed under water face

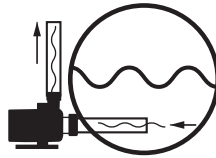

Inline

The pump should be placed under water level

Typical Installations

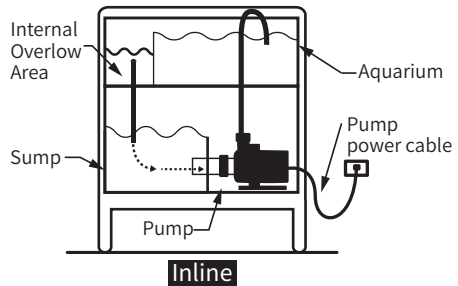
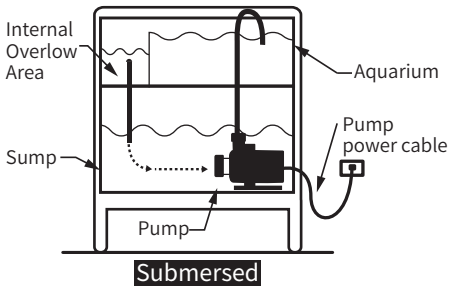

Adjustable Volute

The volute can be rotated for alternative plumbing configurations.

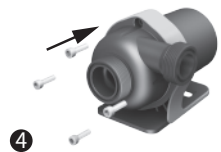
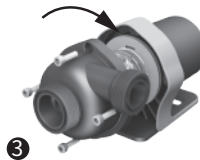
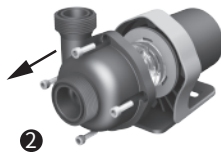
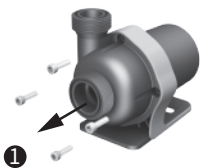

Installation instruction

- ⊙ Installation of the connector requires the correct size ABS plumbing and cement.
- ⊙ Make sure the ABS plumbing and the pump are indeed engaged, and then allow the ABS cement to properly dry before operating.

- ① Install the O-rings on the intel and outlet
- ② Slide the union collar onto the pipe
- ③ Apply ABS cement to the inside of the union coupling and slide on to the bottom of the pipe

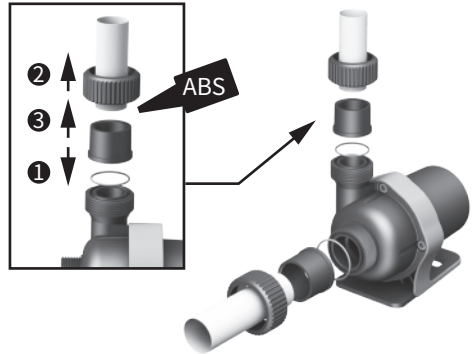

Maintenance

Very rare maintains to MAGNUS DC pumps are required in clear fresh water, but while MAGNUS DC pump is being used in the following situation, we recommend the users should check and clean the pump in every 6 months or even in shorter period.

- ⊙ Muddy fresh water
- ⊙ Salt water
- ⊙ Hard water, high K-value water, high mineral water

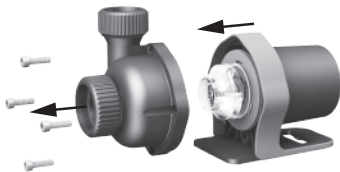

After disconnect the power,unscrew the pump volute and check if any stocks in the pump impeller and volute.



Pull out the shaft to check if any mud, sands on the surface and clean the shaft house inside with fresh water or detergent. Make sure wash out the detergent by fresh water.

Warning

- ⦿ Do not connect the pump controller to others power except original power adapter.
- ⦿ Do not use the pump in flammable liquid. Use this pump in clean fresh water or salt water only.
- ⦿ Do not use the pump in water over 40°C.
- ⦿ Do not run the pump at the place 2.5m deeper underwater.
- ⦿ Do not use the pump in swimming pool.
- ⦿ Children are not allowed to operate or use the pump without adult supervision.
- ⦿ Do not put fingers or others object in front of the inlet or outlet of the pump.
- ⦿ Do not pull or drag the cables which connected with the pump, controller and adapter.
- ⦿ The pump can't be cleaned and maintained unless disconnect the power.

Every MANGUS DC pump is having series number on the body of pump. If you need to have after sale service or technical support, you might need to show your S/N no. to your local retailers or distributors, as well as your purchasing evidence, like sales invoice or warranty card.

If the controllers or the AC/DC adaptor is not working, contact your retailers and ask for a new replacement with your pump still in Warranty.

Please do not dispose this product as unsorted municipal waste.



Limited Warranty

The MAGNUS DC pump is guaranteed for a period of 24 months from date of purchase for material or manufacturing defects.

The warranty is valid only when the warranty card is properly completed, and upon presentation of the proof of purchase consisting of original invoice or sales slip indicating the date of purchase, retailer's name, type and serial number of the product.

If the warranty card is not available, the MAGNUS DC pump is guaranteed only for a period of 13 months from manufacture date.

This limited warranty does not cover any damage to this product that results from below specific conditions.

- ⦿ Malfunction of products results from improper installation accident, natural disaster, and artificial operation.
- ⦿ Un-authorized disassembly, repair or modification of the product or accessories.
- ⦿ Warranty card or identification information has been altered, obliterated or removed.
- ⦿ Serial number of product does not match or be damaged or not clear enough to identify.
- ⦿ Products have been sold not through authorized agent, direct distributors, and resellers as well.
- ⦿ Using any other thing than the specified consumables.
- ⦿ The warranty excludes normal depletion of consumable parts unless failure has occurred due to a defect in materials or workmanship.
- ⦿ Failure or damage caused during transport or fall after the purchase.
- ⦿ Failure and damage occurred after the warranty period.

User Memo

Name:
Phone:
Email:
Address:

Warranty Card

Type:
Serial No.:
Distributor:
Retailer:
Date of Purchase:
Yea 20 Month Day
Retailer's Seal:

Welcome to register your product online at www.SUNPOLE.com.tw.



Follow us on Facebook

www.facebook.com/SUNPOLE.Aquarium